

PIPE CLEANING MACHINE TORNADO

Semi-automatic pipe cleaning machine up to 1100 bar

Z 71-1e

01.04.2008

Seite/Page 1/2

Applications

- Cleaning of fully or partially blocked pipelines in various industries removing rubber (e.G. at airports)
- Removing cement, plastics, bauxite, coke and much more from steel, plastic and concrete pipes, etc.

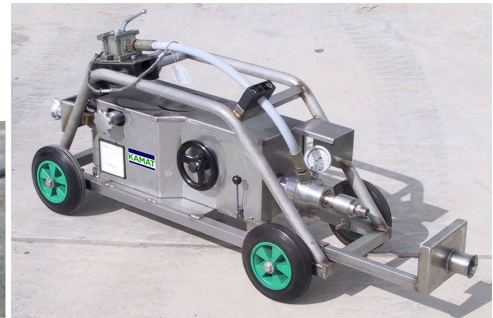

Technical Data

Length:	1016 mm	Speed:	6 - 350 rpm
Width:	330 mm	Air pressure:	6 bar
Height:	560 mm	Air consumption:	max. 2, 83 m ³ / min
Weight:	ca. 65 kg	HP input:	M 24x1.5 DKO-S
Flow:	max. 200 l/min	Output:	M 24x1.5 DKO-S
Working pressure:	max. 1100 bar	Cleaning pipe:	> Ø 40 - Ø 1500 mm (L = max. 300 m) straight pipe length, without elbows

Part No. 7010382

Design

- Robust stainless steel tubular frame; mobile with 4 plastic wheels with rubber tyres
- Infinitely variable two-step gearbox and automatic friction clutch
- High pressure rotating joint DN 12
- Servicing unit for air supply and air motor
- High pressure ball valve for shutting-off and pressure gauge
- Tachometer

Ancillary Equipment

- Advance device PUSHER for direction changes of the hose lines
- Positioning hose guide with spray guard that fits protected hose DN 50 with quick release coupling; useable for a variety of pipes and heat exchanger sizes
- Protection hose DN 50 with quick release coupling
- HP hoses in various widths and lengths with connecting nipples and reducers
- Standard and special nozzles for various applications

Cleaning of other pipes (sizes and lengths) on request

KAMAT GmbH & Co. KG

Salinger Feld 10, 58454 Witten, Germany,
Fon +49 (0) 23 02 / 89 03 - 0, Fax +49 (0) 23 02 / 80 19 17, info@KAMAT.de, www.KAMAT.de
Technische Änderungen vorbehalten / Technical data subject to change without notice



PIPE CLEANING MACHINE TORNADO

Semi-automatic pipe cleaning machine up to 1100 bar

Z 71-1e

01.04.2008

Seite/Page 2/2

Connections and Accessories

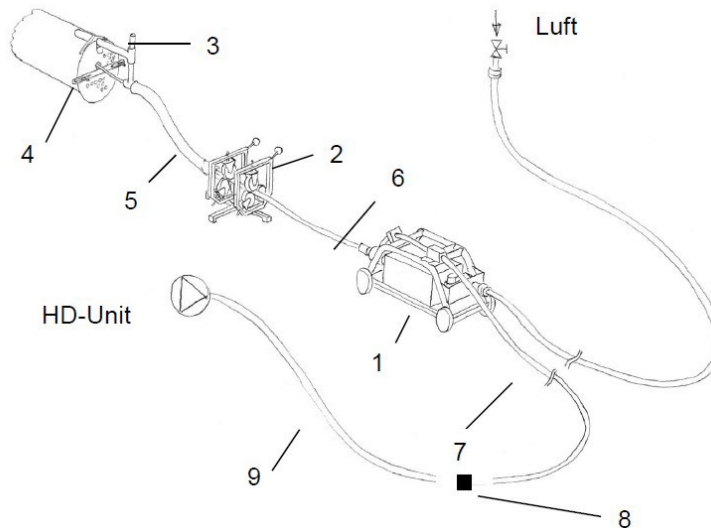

Item	Description	Part no.
1	Tornado	7010382
2	Advance device PUSHHER	7010383
3	Positioning hose guide	7010801
4	Spray guard for pipe 300 - 600 mm	7010802
5	Protected hose ID 50 x 10 m with quick release coupling	7010384
6	HP-Hose DN 12 - 1100 bar - both ends with fitting M 24x1.5 DKO 10 m 20 m 40 m Double nipple M 24x1.5 DKO (for hose connecting)	7009339 7000495 7000496 1050671
7	HP-Hose DN 12 x 20 m - 1100 bar both ends with fitting M 24x1.5 DKO	7000495
8	Reduction double nipple M 24x1.5 DKO – M 36x2 DKO	1050673
9	HP-Hose ID 20 - 1000 bar - both ends with fitting M 36x2 DKO 20 m 40 m Double nipple M 36x2 DKO (for hose connecting)	7000519 7000520 1050672
Pipe cleaning nozzles and nozzle carriers available for various applications see page Z 71-3 e		



It is not permitted to connect a number of hoses for cleaning pipe lines which have a number of bends in close succession.
There is an increased accident risk due to the lengths of rigid sections if several hoses are connected to each other.