

Model LP301AGBHS

Triplex Ceramic
Plunger Pump
Operating Instructions/
Manual

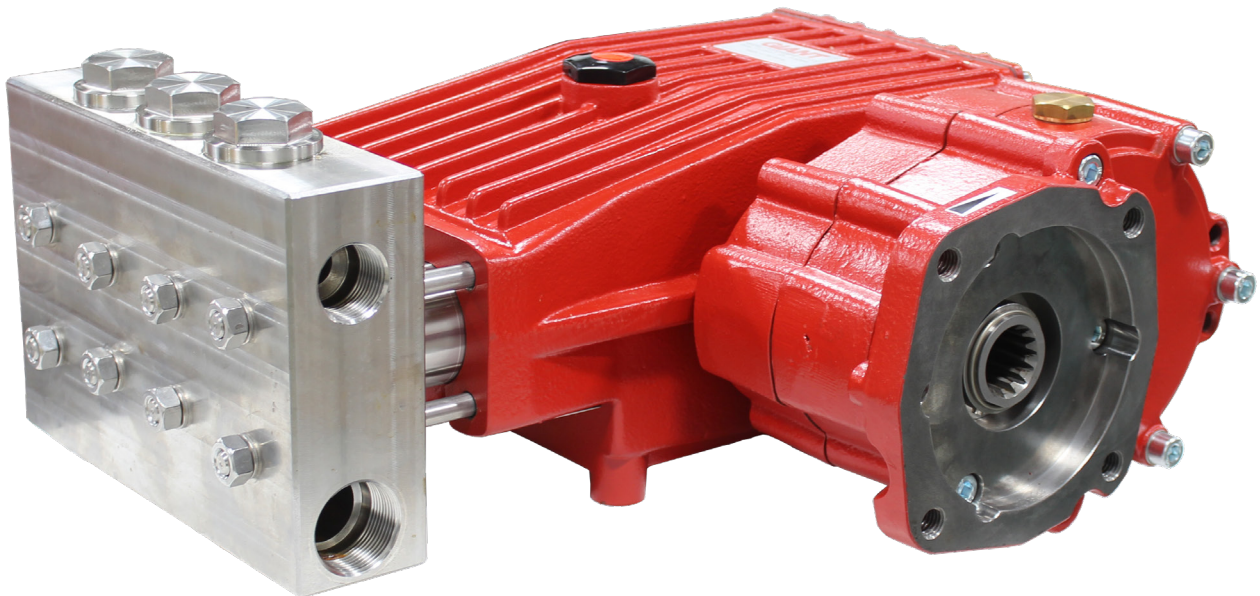

Contents:

Installation Instructions:	page 2
Specifications:	page 3
Exploded View:	page 4
Parts List/Kits:	page 5
Repair Instructions:	pages 6-9
Torque Specifications:	page 8
Trouble Shooting:	page 10
Maintenance/Spare Parts List:	page 10
Dimensions:	page 11
Warranty Information:	back page

Installation Instructions

Operation and Maintenance

Check oil level prior to starting and ensure trouble free water supply.

IMPORTANT! If there is a **danger of frost**, the water in the pump and in the pump fittings (particularly the unloader valve) must be emptied. The second discharge port can also be used and the pump run “dry” for 1-2 minutes for this purpose.

Oil: Use only 118 fluid ounces (3.5 L) of SAE 90 Industrial gear lube oil. (Giant’s p/n 01154)

Initial change after 50 operating hours and then every 1000 operating hours, or after one year if used less.

Caution! When operating in damp places or with high temperature fluctuations, condensate (frothy oil) might occur in the gear box. In this situation, change the oil immediately. **Keep NPSH under control.**

Maximum input pressure is 145 PSI (10 bar), the maximum suction head is -4.35 PSI (-0.3 bar). Make sure that suction pulsation is sufficiently dampened. Water column resonance must be avoided.



Safety Rules

Pump operation without safety valve as well as any excess in temperature or speed limits automatically voids the warranty. The safety valve must be regulated in accordance with the guidelines for liquid spraying units so that the admissible operating pressure can not be exceeded by more than 10%.

When the pump is in operation, the open shaft end must be covered up by a shaft protector (21). For direct drive operations, the driven shaft side and coupling must have a guard over the connected area.

Pressure in discharge line and in pump must be at zero before any maintenance to the pump takes place. Close the fluid supply to the inlet port(s). Disconnect fuses to ensure that the driving motor does not accidentally get switched on. Make sure that all parts on the pressure side of the unit are vented and refilled, with pressure at zero, before starting the pump.

In order to prevent air, or air/water mixture being absorbed and to prevent cavitation occurring, the pump-npshr, positive suction head and water temperature must be kept under control.

Required NPSH refers to water: Specific weight 0.0624 lb/ft³ (1kg/dm³), viscosity 1°E at maximum permissible revolutions.

Cavitation and/or compression of gases lead to uncontrollable pressure kicks which can ruin pump and unit parts and also be dangerous to the operator or anyone standing nearby.

Giant pumps are suitable for pumping clean water and other non-aggressive or abrasive media with a specific weight similar to water.

Before pumping other liquids - especially inflammable, explosive and toxic media - the pump manufacturer must under all circumstances be consulted with regard to the resistance of the pump material. It is the responsibility of the equipment manufacturer and/or operator to ensure that all pertinent safety regulations are adhered to.

NOTE: Contact Giant Industries for Service School Information. Phone: (419)-531-4600

Model LP301AGBHS Specifications

	<u>U.S.</u>	<u>Metric</u>
Flow (Continuous)	14.2 GPM	53.6 L/min
Flow (Intermittent).....	18.0 GPM	68.1 L/min
Pressure	4000 PSI	275 bar
Crankshaft Speed (Continuous)		1000 RPM
Crankshaft Speed (Intermittent)		1268 RPM
Input Speed (Continuous).....		2000 RPM
Input Speed (Intermittent).....		2536 RPM
Power Required (continuous).....	37.9 BHP	28.3 kW
Power Required (intermittent).....	50 BHP	37 kW
Inlet Pressure	-4.35 to 145 PSI	-0.3 to 10 Bar
Plunger Diameter.....	0.95"	24 mm
Stroke	1.65"	42 mm
Crankshaft Bore.....		SAE-C Spline 14T 12/24 DP
Crankshaft Mounting		Either Side
Shaft Rotation.....		Hydraulic Gear Toward Back of the Pump
Temperature of Pumped Fluids	140 °F	60 °C
Inlet Ports		1-1/4" BSP
Discharge Ports		1" BSP
Crankcase Oil Capacity	118 fl.oz.	3.5t Liters
Weight	119 lbs.	54 kg
NPSHR.....	25.9 ft.-head	7.9 mWs

*Intermittent duty for pump speeds in excess of 805 RPM

LP301A PULLEY SELECTION AND HORSEPOWER REQUIREMENTS					
RPM	GPM	2500 PSI	3000 PSI	3500 PSI	4000 PSI
500	7.05	12.2	14.6	17.0	19.4
640	9.02	15.6	18.7	21.8	24.9
750	10.57	18.2	21.9	25.5	29.2
805	11.35	19.6	23.5	27.4	31.3
865	12.2	21.0	25.2	29.4	33.7
940	13.25	22.8	27.4	32.0	36.6
1000	14.2	24.5	29.4	34.3	39.2
1268	18.0*	31.0	37.2	43.4	49.7*

*Intermittent duty only

Pump Mounting Selection Guide
Rails 07357 - Plated Steel Channel Rails (L=11.75"x W=1.88"x H=3.00")

Exploded View LP301AGBHS

Important! The stainless steel valve plugs (48) can seize when being screwed out of the casing. To release tension beforehand, strike the plugs 1-2 times with a steel hammer on the top before screwing them out. Coat threads with antiseize (e.g. Fel-Pro Nickel Anti-Seize 51119)

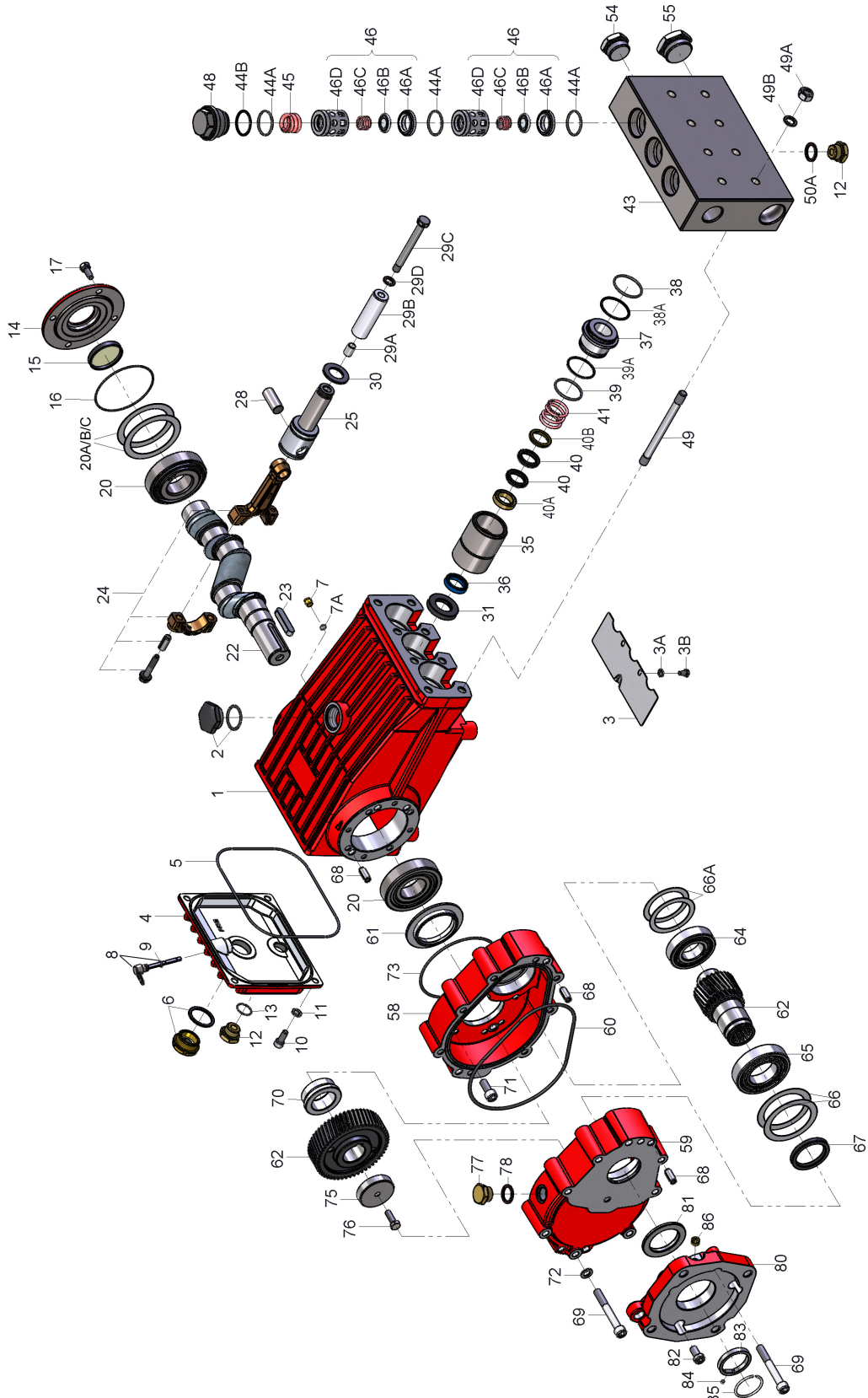

Parts List - LP301AGBHS

ITEM	PART	DESCRIPTION	QTY	ITEM	PART	DESCRIPTION	QTY
1	03190	Crankcase	1	44A	07150	O-Ring	9
2	13000	Oil Filler Plug Assembly	1	44B	06266	Support Ring for O-Ring	3
3	05940	Cover Plate	1	45	06078	Compression Spring	3
3A	07223-0100	Spring Ring	2	46	07060	Valve Assembly (46A-46D)	6
3B	05051	Hexagon Screw	2	46A	07064	Valve Seat	6
4	06085	Crankcase Cover	1	46B	07063	Valve Plate	6
5	07104	O-ring, Crankcase Cover	1	46C	07062-0100	Valve Spring	6
6	05943	Oil Sight Glass w/Gasket	1	46D	07066	Spacer Pipe	6
7	03191	Plug	2	48	06077	Plug	3
7A	01009	O-Ring	2	49	07157	Stud bolt	8
8	06086	Oil Dipstick Assembly	1	49A	07158	Hexagon Nut	8
9	01009	O-Ring, (For Dipstick)	1	49B	07159	Disc	8
10	01010	Cylinder Screw	4	50A	07661	Copper Seal Ring	1
11	01011-0400	Spring Ring	4	54	13044*	Plug, 1" BSP	1
12	07109	Plug, 1/2" BSP	3	55	13151*	Plug, 1-1/4" BSP	1
13	06015	O-Ring	1	58	03194	Bottom Casing for Gear	1
14	07111	Bearing Cover	1	59	03195	Top Casing for Gear	1
15	08439	Lid	1	60	03196	O-Ring	1
16	07113	O-Ring for Bearing Cover	1	61	03197	Centering Ring for Gear	1
17	07114	Hexagon Screw	4	62	03329	Gear Wheel Set 1:2.0	1
20	07116	Taper Roller Bearing	2	64	03199	Cylinder Roller Bearing	1
20A	07117	Shim, 0.1 mm	1-3	65	03200	Cylinder Roller Bearing	1
20B	13001	Shim, 0.15 mm	1-3	66	03201	Shim, 0.1 mm	1-2
20C	04091	Shim, 0.2 mm (May not be present)	1-3	66A	07249	Shim, 0.1 mm	1-2
22	03192	Crankshaft	1	67	05058	Radial Shaft Seal	1
23	13243	Key	1	68	04744	Cylindrical Pin	4
24	13340	Connecting Rod Assembly	3	69	03202	Hexagon Socket Screw	8
25	13341	Crosshead Assembly	3	70	03203	Spacer Ring for Gear	1
28	13232	Crosshead Pin	3	71	07008	Hexagon Socket Screw	4
29A	07125	Centering Sleeve	3	72	08041	Washer	3
29B	07127	Plunger Pipe	3	73	03204	O-Ring	1
29C	13031	Tensioning Screw	3	75	03205	Disc for Crankshaft	1
29D	07755	Copper Ring	3	76	03206	Hexagon Screw	1
30	07779	Oil Scraper	3	77	07109	Plug, 1/2" BSP	2
31	07133	Oil Seal	3	78	06272	Copper Seal Ring, 1/2"	2
35	13364	Seal Sleeve	3	80	03291	Flange	1
36	13238	Leakage Seal	3	81	03292	Centering Ring	1
37	13240	Seal Case	3	82	03293	Hexagon Socket Screw	1
38	07140	O-Ring, Seal Case	3	83	03294	Ring for Speed Sensor	1
38A	13241	Support Ring for 38	3	84	03295	Magnet for Speed Sensor	1
39	12055	O-Ring	3	85	03296	Clip Ring	1
39A	07693	Support Ring for 39	3	86	03297	Plug	1
40	06083	V-Sleeve	6				
40A	13366	Pressure Ring	3				
40B	13367	Guide Ring for 40	3				
41	07338	Pressure Spring	3				
43	13040	Valve Casing	1				

*BSP to NPT Adapters/Seals (sold separately)
 Inlet Port = 13377 (Adapter) / 13376 (Seal)
 Discharge Port = 13373+ (Adapter) / 13372 (Seal)

* rated up to 3000 PSI. For higher pressure adapters, contact Giant.

Repair Kits - LP301AGBHS

Plunger Packing Kit

09459

Item	Part #	Description	Qty.
36	13238	Leakage Seal	3
38	07140	O-Ring	3
38A	13241	Support Ring	3
39	12055	O-Ring	3
39A	07693	Support Ring	3
40	06083	V-Sleeve	6
40A	13366	Pressure Ring	3

Oil Seal Kit

09577

Item	Part #	Description	Qty.
31	07133	Oil Seal	3

Valve Repair Kits

09196

Item	Part #	Description	Qty.
44A	07150	O-Ring	6
44B	06266	Support Ring	3
46A	07064	Valve Seat	3
46B	07063	Valve Plate	3
46C	07062-0100	Valve Spring	3

09196A

Item	Part #	Description	Qty.
44A	07150	O-Ring	9
44B	06266	Support Ring	3
46A	07064	Valve Seat	6
46B	07063	Valve Plate	6
46C	07062-0100	Valve Spring	6

REPAIR INSTRUCTIONS - LP301AGBHS

NOTE: Always take time to lubricate all metal and non-metal parts with a light film of oil before reassembling. This step will help ensure proper fit, at the same time protecting the pump non-metal parts (elastomers) from cutting and scoring.

TO CHECK VALVES



- 1) Loosen and remove tension plugs (48) with a 36mm socket wrench.



- 2) Remove the support ring (44B), O-ring (44A) and tension spring (45).



- 3) Take out discharge valve assemblies (46) by pulling them upwards out of the valve casing (43) with a snap-ring tongs or any other pull-off device. Then remove inlet valves in the same way.

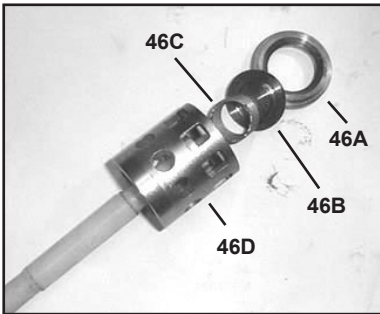

- 4) Loosen valve seats (46A) and valve spring (46C) from spacer pipe (46D) by lightly hitting the valve plate (46B) with a plastic stick. Check sealing surface and replace worn parts. Reassemble with new O-rings (44A) if possible and oil them before installing.



- 5) Tighten up tension plugs (48) to 107 ft.-lbs. (145 NM)

REPAIR INSTRUCTIONS - LP301AGBHS

NOTE: Always take time to lubricate all metal and non-metal parts with a light film of oil before reassembling. This step will help ensure proper fit, at the same time protecting the pump non-metal parts (elastomers) from cutting and scoring.

TO CHECK SEALS AND PLUNGER PIPE

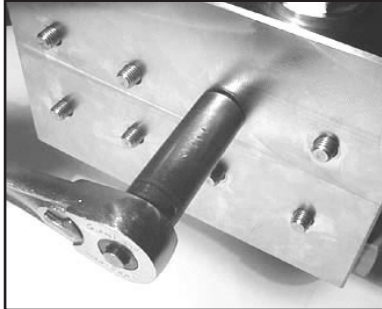

6) Loosen the 8 nuts (49A) with a 19mm socket and pull off valve casing (43) to the front.



7) Remove the seal sleeve (35) from the manifold and /or crankcase.



8) Remove seal case (37) from seal sleeve (35).

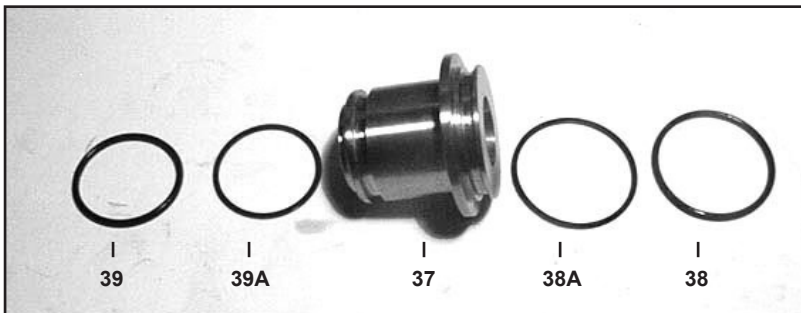

9) Check O-rings (39 & 38) and support rings (39A & 38A) on seal case (37).



10) Remove leakage seal (36) from the seal sleeve. If worn or damaged replace with new seal.

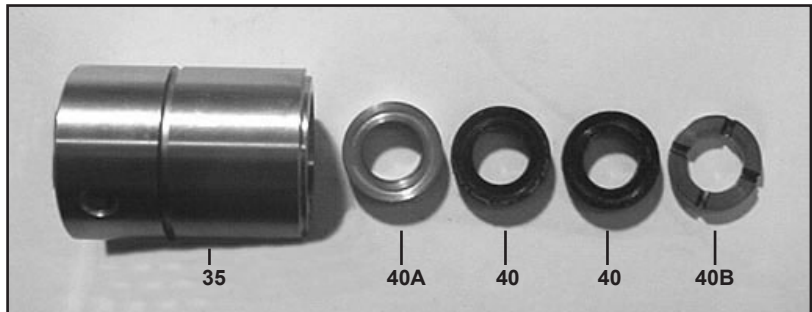

11) Remove the pressure ring (40A), v-sleeves (40), sleeve, and support ring (40B), from the seal sleeve. Remove the pressure spring (41). Examine seals carefully and replace if worn. Clean surfaces of seal sleeves (35) which come in contact with the crankcase (1) and sealing surfaces of valve casing (43).

REPAIR INSTRUCTIONS - LP301AGBHS

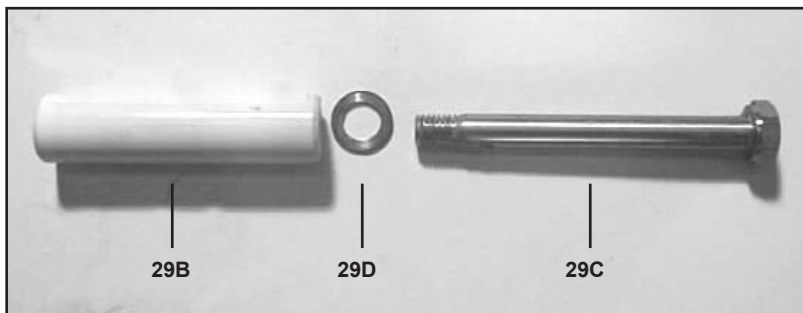

12) Check plunger surface (29B). If plunger pipe is worn out, loosen tension screws (29C) with a 15mm socket and pull off plunger pipe to the front. Clean front surface of plunger (29B) thoroughly. Apply a small drop of loctite to tension screw. Put a **new** crush washer (29D) onto tension screw. Put a thin coat of glue (Loctite) on the ring (or ceramic plunger side) and tighten screw to 265 in.-lbs. (30 NM).

13) Replace complete seal sleeve (35)/seal case (37) assembly into crankcase (1). Make sure that the weep hole points downward. **Note: To replace the oil seals (31), you will need to disassemble the gear end (see instructions below).**

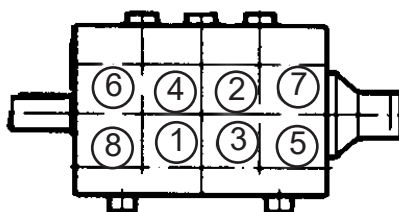
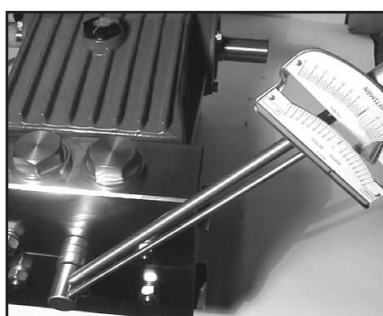

14) Place entire manifold/seal sleeve assembly over the studs and push firmly until seated against the crankcase.

15) Tighten hex nuts (49A) in a crosswise pattern (shown above) to 59 ft.-lbs. (80 Nm).

LP301AGBHS TORQUE SPECIFICATIONS

Position	Item#	Description	Lubrication Info	Torque Amount
1	03190	Crankcase	Molycote Cu-Paste	
6	05943	Oil Sight Glass	Loctite 572	29 ft.-lbs. (40 Nm)
10	01010	Cylinder Screw		221 in.-lbs. (25 Nm)
12	07109	Plug, 1/2" BSP		29 ft.-lbs. (40 Nm)
17	07114	Hexagon Screw		221 in.-lbs. (25 Nm)
24	13340	Inner Hexagon Screw		22 ft.-lbs. (30 Nm)
29C	13031	Tension Screw	Loctite 243	26 ft.-lbs. (35 Nm)
29D	07755	Copper Ring	Loctite 577	
31	07133	Oil Seal	Loctite 403	
48	06077	Plug, Discharge	Pro Pack 550	107 ft.-lbs. (145 Nm)
49	07157	Stud Bolt	Loctite 270	
49A	07158	Hexagon Nut		59 ft.-lbs. (80 Nm)

REPAIR INSTRUCTIONS - LP301AGBHS

TO DISMANTLE GEAR END

After removing valve casing (43) and plunger pipe (29B), drain the oil. Remove the gear cover (4) and bearing cover (14). Loosen connecting rod screws (24A) and push the front of the connecting rod (24) forward as far as possible into the crosshead guide.

IMPORTANT! Connecting rods (24) are marked for identification. Do not twist connecting rod halves. Connecting rod is to be reinstalled in the same position on shaft journals.

IMPORTANT! Do not bend the connecting rod (24) shanks. Check crankshaft (22) and connecting rod (24) surfaces, radial shaft seals (15) and taper roller bearings (20).

To remove the oil seals (31) use a wooden rod and sharply hit down on the oil seals from the crankcase (1). Note: when replacing the oil seals, apply a small amount of locktight to the outside edges of each oil seal before re-inserting them into the crankcase.

To Dismantle Reduction Gear

Remove screws (69). Remove bottom casing (58); it may be necessary to use a rubber mallet. Remove screw (76) and disc (75). Pull gear wheel (62) off of the shaft. Remove screws (71), top casing (58) and centering ring (61).

Turning the crankshaft (22) slightly, hit it out carefully to the side with a rubber hammer.

To Reassemble

Using a soft tool, press in the outer bearing ring until the outer edge lines up with the outer edge of the bearing hole. Remove bearing cover (14) together with radial shaft seal (15) and o-ring (16). Fit crankshaft (22) through bearing hole on the opposite side. Press in outer bearing and tighten it inwards with the bearing cover, keeping the crankshaft in vertical position and turning slowly so that the taper rollers of the bearings touch the edge of the outer bearing ring. Adjust axial bearing clearance to at least 0.1mm and maximum 0.15mm by placing fitting discs (20A and 20B) under the bearing cover.

IMPORTANT! After assembly has been completed, the crankshaft should turn easily with very little clearance. Tighten connecting rod screws (24A) to 22 ft.-lbs. (30 Nm) Re-assemble the fluid end (see instructions above).

If cylinder roller bearing (65) was removed, heat them up (before pressing onto the pinion shaft). Slightly press the gearwheel (62) onto the crankshaft (22) so that remaining portion of the gearwheel set can be positioned in the correct manner. Carefully, tap the gearwheel and the pinion (simultaneously) onto the crankshaft and into the bearing seat. Reassemble remaining gearbox parts making sure not to damage the radial shaft seal (67) or the o-ring (60).

Important! Before putting the pump into operation, turn the reduction gear (by hand) at least four times in each direction (to ensure proper alignment).

Reassemble connecting rods (24), shaft cover (14) and crankcase cover (4) and properly torque screws (17 & 10).

Pump System Malfunction

<u>MALFUNCTION</u>	<u>CAUSE</u>	<u>REMEDY</u>
The Pressure and/or the Delivery Drops	Worn packing seals Broken valve spring Belt slippage Worn or Damaged nozzle Fouled discharge valve Fouled inlet strainer Worn or Damaged hose Worn or Plugged relief valve on pump Cavitation Unloader	Replace packing seals Replace spring Tighten or Replace belt Replace nozzle Clean valve assembly Clean strainer Repair/Replace hose Clean, Reset, and Replace worn parts Check suction lines on inlet of pump for restrictions Check for proper operation
Water in crankcase	High humidity Worn seals	Reduce oil change interval Replace seals
Noisy Operation	Worn bearings Cavitation	Replace bearings, Refill crankcase oil with recommended lubricant Check inlet lines for restrictions and/or proper sizing
Rough/Pulsating Operation with Pressure Drop	Worn packing Inlet restriction Accumulator pressure Unloader Cavitation	Replace packing Check system for stoppage, air leaks, correctly sized inlet plumbing to pump Recharge/Replace accumulator Check for proper operation Check inlet lines for restrictions and/or proper size
Pressure Drop at Gun	Restricted discharge plumbing	Re-size discharge plumbing to flow rate of pump
Excessive Leakage	Worn plungers Worn packing/seals Excessive vacuum Cracked plungers Inlet pressure too high	Replace plungers Adjust or Replace packing seals Reduce suction vacuum Replace plungers Reduce inlet pressure
High Crankcase Temperature	Wrong Grade of oil Improper amount of oil in crankcase	Giant oil is recommended Adjust oil level to proper amount

Preventative Maintenance Check List & Recommended Spare Parts List						
Check	Daily	Weekly	50 hrs	Every 500 hrs	Every 1500 hrs	Every 3000 hrs
Oil Level/Quality	X					
Oil Leaks	X					
Water Leaks	X					
Belts, Pulley		X				
Plumbing		X				
Recommended Spare Parts						
Oil Change (1 Gallon) p/n 01154			X	X		
Oil Seal Kit (1 kit/pump) (see page 5 for kit list)					X	
Seal Spare Parts (1 kit/pump) (see page 5 for kit list)					X	
Valve Spare Parts (1 kit/pump) (see page 5 for kit list)						X

LP301AGBHS Dimensions - Inches (mm)

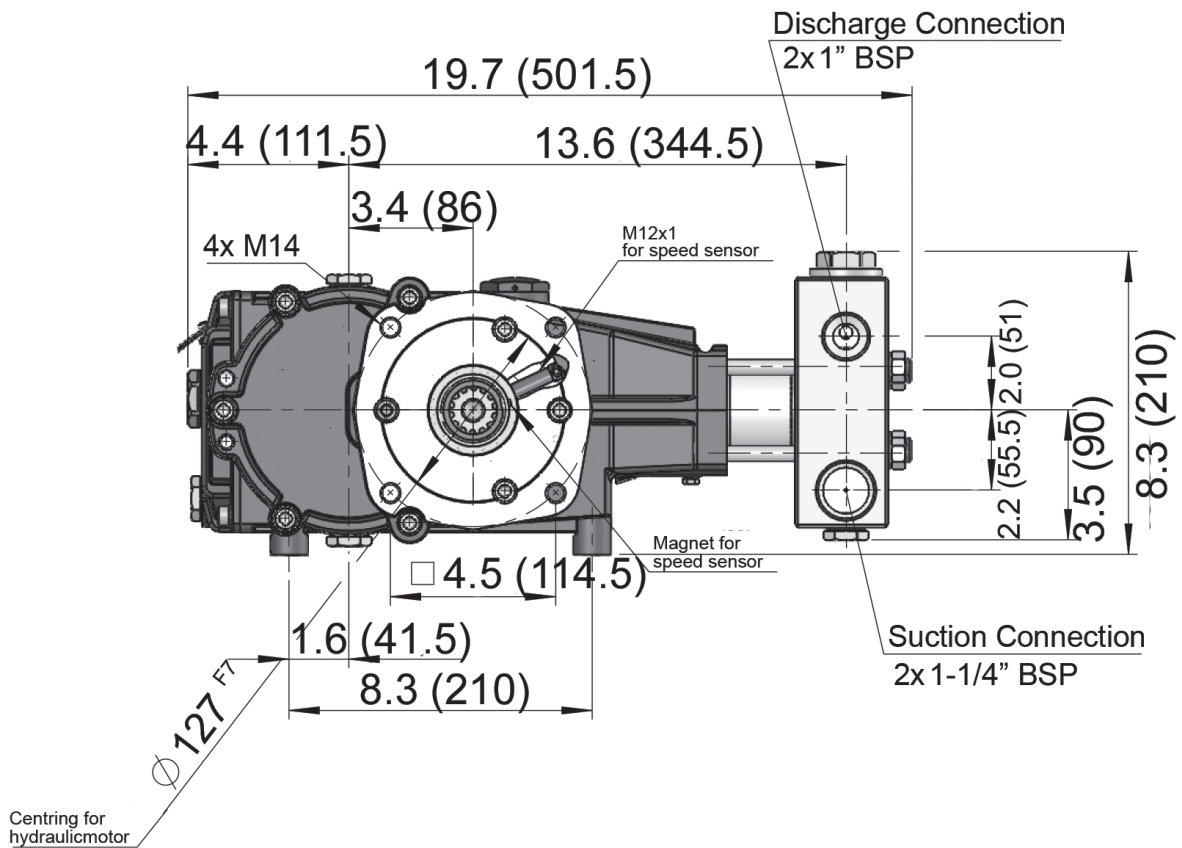
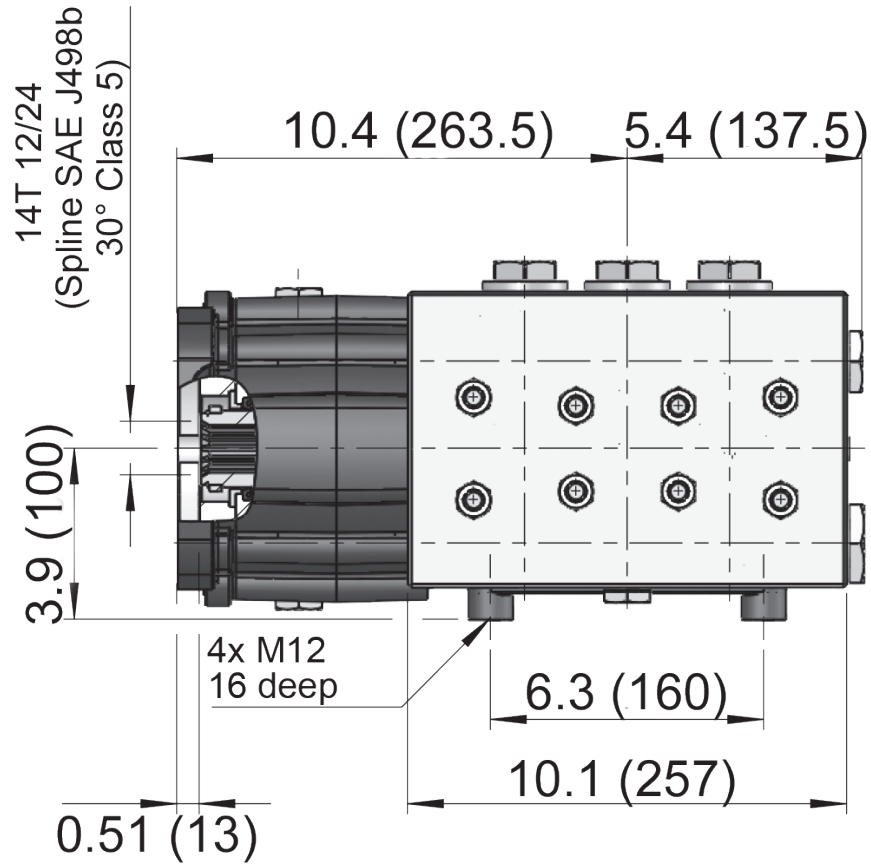

GIANT INDUSTRIES LIMITED WARRANTY

Giant Industries, Inc. pumps and accessories are warranted by the manufacturer to be free from defects in workmanship and material as follows:

1. Five (5) years from the date of shipment for all pumps used in portable pressure washers with NON-SALINE, clean water applications.
2. Two (2) years from the date of shipment for Giant pumps used in car wash applications.
3. One (1) year from the date of shipment for all other Giant industrial and consumer pumps.
4. Six (6) months from the date of shipment for all rebuilt pumps
5. Ninety (90) days from the date of shipment for all Giant accessories.

This warranty is limited to repair or replacement of pumps and accessories of which the manufacturer's evaluation shows were defective at the time of shipment by the manufacturer. The following items are NOT covered or will void the warranty:

1. Defects caused by negligence or fault of the buyer or third party.
2. Normal wear and tear to standard wear parts.
3. Use of repair parts other than those manufactured or authorized by Giant.
4. Improper use of the product as a component part.
5. Changes or modifications made by the customer or third party.
6. The operation of pumps and or accessories exceeding the specifications set forth in the Operations Manuals provided by Giant Industries, Inc.

Liability under this warranty is on all non-wear parts and limited to the replacement or repair of those products returned freight prepaid to Giant Industries which are deemed to be defective due to workmanship or failure of material. A Returned Goods Authorization (R.G.A.) number and completed warranty evaluation form is required prior to the return to Giant Industries of all products under warranty consideration. Call (419)-531-4600 or fax (419)-531-6836 to obtain an R.G.A. number.

Repair or replacement of defective products as provided is the sole and exclusive remedy provided hereunder and the MANUFACTURER SHALL NOT BE LIABLE FOR FURTHER LOSS, DAMAGES, OR EXPENSES, INCLUDING INCIDENTAL AND CONSEQUENTIAL DAMAGES DIRECTLY OR INDIRECTLY ARISING FROM THE SALE OR USE OF THIS PRODUCT.

THE LIMITED WARRANTY SET FORTH HEREIN IS IN LIEU OF ALL OTHER WARRANTIES OR REPRESENTATION, EXPRESS OR IMPLIED, INCLUDING WITHOUT LIMITATION ANY WARRANTIES OR MERCHANTABILITY OR FITNESS FOR A PARTICULAR PURPOSE AND ALL SUCH WARRANTIES ARE HEREBY DISCLAIMED AND EXCLUDED BY THE MANUFACTURER.



WARNING: This product might contain a chemical known to the State of California to cause cancer, and birth defects or other reproductive harm.
For more information go to www.P65Warnings.ca.gov



GIANT INDUSTRIES, INC., 900 N. Westwood Ave., Toledo, Ohio 43607
PHONE (419) 531-4600, FAX (419) 531-6836, www.giantpumps.com
© Copyright 2021 Giant Industries, Inc.