

# Model 22107-51

# 316 S.S Regulator/ Safety Valve

## Features

- Strong 316 S.S. structure suitable for food industry.
- Compact dimensions and high performance.
- New Teflon backup ring for smoother operation and longer life.
- Adjustable locknut to control the max. pressure.
- Easy maintenance - inner part is extractable from the top.

## Dimensions - mm [in]

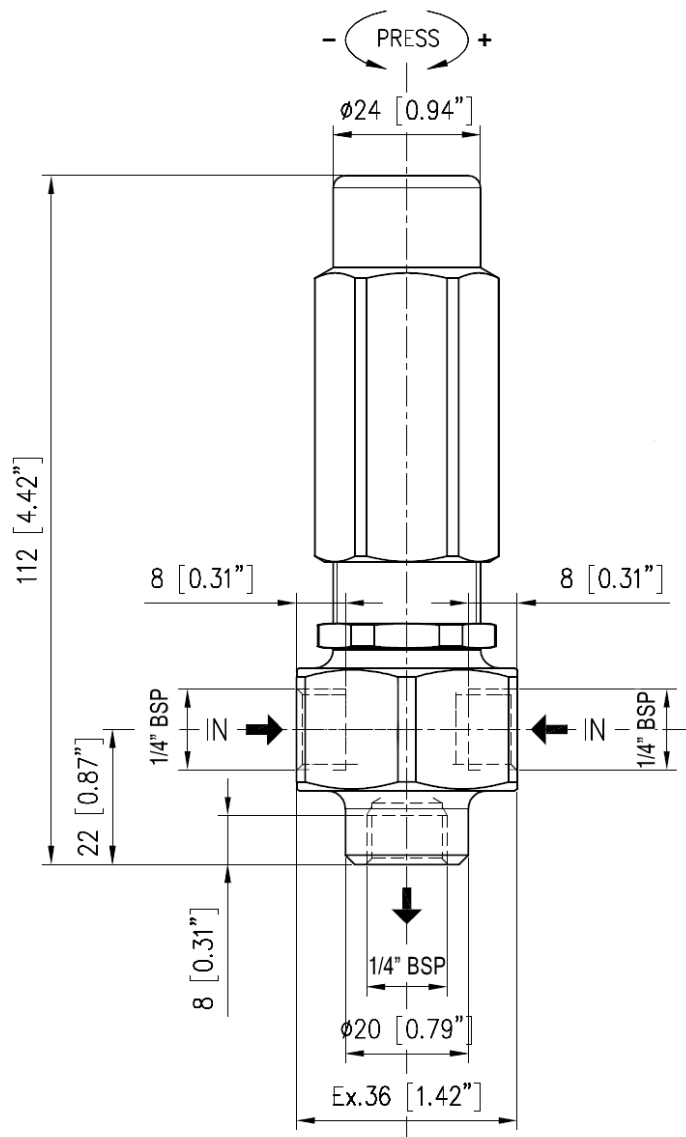

## Operating Conditions

<b>Maximum Flow:</b>	5.3 GPM (20 L/min)
<b>Rated Pressure:</b>	1,813 PSI (125 Bar)
<b>Permissible Pressure:</b>	2,030 PSI (140 Bar)
<b>Maximum Working Temp.:</b>	194° F (90° C) (short intervals only)
<b>Inlet Port:</b>	1/4" BSP
<b>By-Pass:</b>	1/4" BSP
<b>Weight:</b>	7.6 lbs (3440 g)

**Note:** Always remember to generously lubricate all moving parts with a light weight oil for easy reassembly and to give the moving parts protection when "running in" the unloader.

## Parts & Materials List

Part	Material
Valve Housing, 1/4" F BSP	S.S.T. AISI316
All O-Rings	FKM (Viton 70)
All Backup Rings	PTFE (Teflon)
Ball, 7/32"	Ceramics Alternatively Tungsten Carbide
Ball, 1/4"	S.S.T. AISI420
Seat	S.S.T. AISI316
Piston	S.S.T. AISI316
Spring Guide	S.S.T. AISI303
Spring	S.S.T. AISI302
Locknut	Nickle-pl. Brass
Valve Regulating Knob	Nickle-pl. Brass

# GIANT

Performance Under Pressure

Giant Industries, Inc.

900 N. Westwood Ave. Toledo, Ohio 43607

Phone: 419-531-4600 Fax: 419-531-6836

www.giantpumps.com

© Copyright 2014 Giant Industries, Inc.

10-14 22107-51.indd