

## K 80000 - 5G Quintuplex Plunger Pump

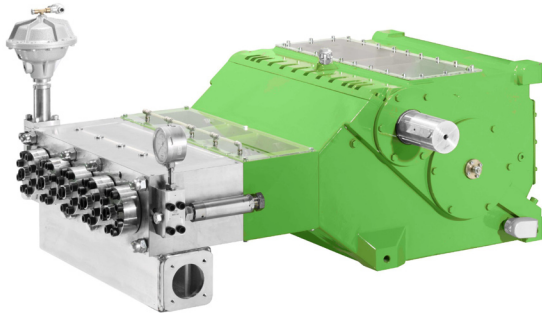

- ◆ Flow rate is based on 100% volumetric efficiency and 68° F (20° C) ambient temperature.
- ◆ Depending on fluid medium, a minimum inlet pressure is required.
- ◆ Depending on rod loading, a minimum crankshaft RPM is required.
- ◆ 7% rest pulsation - dynamically balanced
- ◆ Gear with force-fed lubrication and oil cooling
- ◆ Standard Gear Ratios:  $i = 3.40, 4.09, 4.77, 5.17, \text{ and } 6.21$
- ◆ Weight: 8047 lbs (3650 kg)
- ◆ API 674 specifications available upon request.
- ◆ Contact your local distributor or Giant Industries for use with special mediums. i.e. seawater, glycol, methanol, oils, etc.

| Rated Speed 440 RPM |       |       | Pressure at specific power inputs |        |        |        |        |        |         |        | Pump Head Style |    |   |     |     |
|---------------------|-------|-------|-----------------------------------|--------|--------|--------|--------|--------|---------|--------|-----------------|----|---|-----|-----|
| Type                | FLOW  |       | 536 Hp                            | 400 kW | 670 Hp | 500 kW | 845 Hp | 630 kW | 1072 Hp | 800 kW | A1              | A2 | M | MC1 | MC2 |
|                     | GPM   | L/min | PSI                               | Bar    | PSI    | Bar    | PSI    | Bar    | PSI     | Bar    |                 |    |   |     |     |
| K 80022 - 5G        | 30.9  | 117   | 25738                             | 1775   | 32190  | 2220   | 40600  | 2800   | 50750   | 3500   | X               |    |   |     |     |
| K 80024 - 5G        | 36.7  | 139   | 21605                             | 1490   | 27043  | 1865   | 34075  | 2350   | 43210   | 2980   | X               |    |   |     |     |
| K 80026 - 5G        | 43.1  | 163   | 18415                             | 1270   | 23055  | 1590   | 29000  | 2000   | 36903   | 2545   | X               |    |   |     |     |
| K 80028 - 5G        | 50.2  | 190   | 15878                             | 1095   | 19865  | 1370   | 25013  | 1725   | 31755   | 2190   | X               |    |   |     |     |
| K 80032 - 5G        | 65.5  | 248   | 12180                             | 840    | 15225  | 1050   | 19140  | 1320   | 24288   | 1675   | X               |    |   |     |     |
| K 80036 - 5G        | 82.7  | 313   | 9570                              | 660    | 12035  | 830    | 15153  | 1045   | 19213   | 1325   |                 | X  |   |     |     |
| K 80040 - 5G        | 102.2 | 387   | 7758                              | 535    | 9715   | 670    | 12253  | 845    | 15588   | 1075   |                 | X  |   |     |     |
| K 80045 - 5G        | 129.5 | 490   | 6163                              | 425    | 7685   | 530    | 9643   | 665    | 12253   | 845    |                 | X  |   |     |     |
| K 80050 - 5G        | 159.6 | 604   | 4930                              | 340    | 6235   | 430    | 7830   | 540    | 9933    | 685    |                 | X  |   |     |     |
| K 80055 -5G         | 193.1 | 731   | 4060                              | 280    | 5148   | 355    | 6453   | 445    | 8193    | 565    |                 |    | X |     |     |
| K 80060 -5G         | 229.9 | 870   | 3408                              | 235    | 4278   | 295    | 5438   | 375    | 6888    | 475    |                 |    | X |     |     |
| K 80065 -5G         | 270.0 | 1022  | 2973                              | 205    | 3698   | 255    | 4640   | 320    | 5873    | 405    |                 |    | X | X   |     |
| K 80070 -5G         | 313.1 | 1185  | 2538                              | 175    | 3118   | 215    | 3988   | 275    | 5075    | 350    |                 |    | X | X   |     |
| K 80075 -5G         | 359.3 | 1360  | 2175                              | 150    | 2755   | 190    | 3480   | 240    | 4423    | 305    |                 |    |   | X   |     |
| K 80080 -5G         | 408.7 | 1547  | 1886                              | 130    | 2393   | 165    | 3046   | 210    | 3844    | 265    |                 |    |   | X   |     |
| K 80085 -5G         | 461.6 | 1747  | 1668                              | 115    | 2103   | 145    | 2683   | 185    | 3408    | 235    |                 |    |   | X   |     |
| K 80090 -5G         | 517.3 | 1958  | 1450                              | 100    | 1886   | 130    | 2393   | 165    | 3046    | 210    |                 |    |   | X   |     |
| K 80095 -5G         | 576.5 | 2182  | 1378                              | 95     | 1668   | 115    | 2175   | 150    | 2755    | 190    |                 |    |   | X   |     |
| K 80100 -5G         | 638.5 | 2417  | 1305                              | 90     | 1595   | 110    | 1958   | 135    | 2538    | 175    |                 |    |   |     | X   |
| K 80110 -5G         | 772.7 | 2925  | 1015                              | 70     | 1305   | 90     | 1595   | 110    | 2103    | 145    |                 |    |   |     | X   |
| K 80120 -5G         | 919.9 | 3482  | 870                               | 60     | 1088   | 75     | 1233   | 85     | 1813    | 125    |                 |    |   |     | X   |

Subject to change without notice

# Pump Dimensions mm(in)

## High Pressure Head A

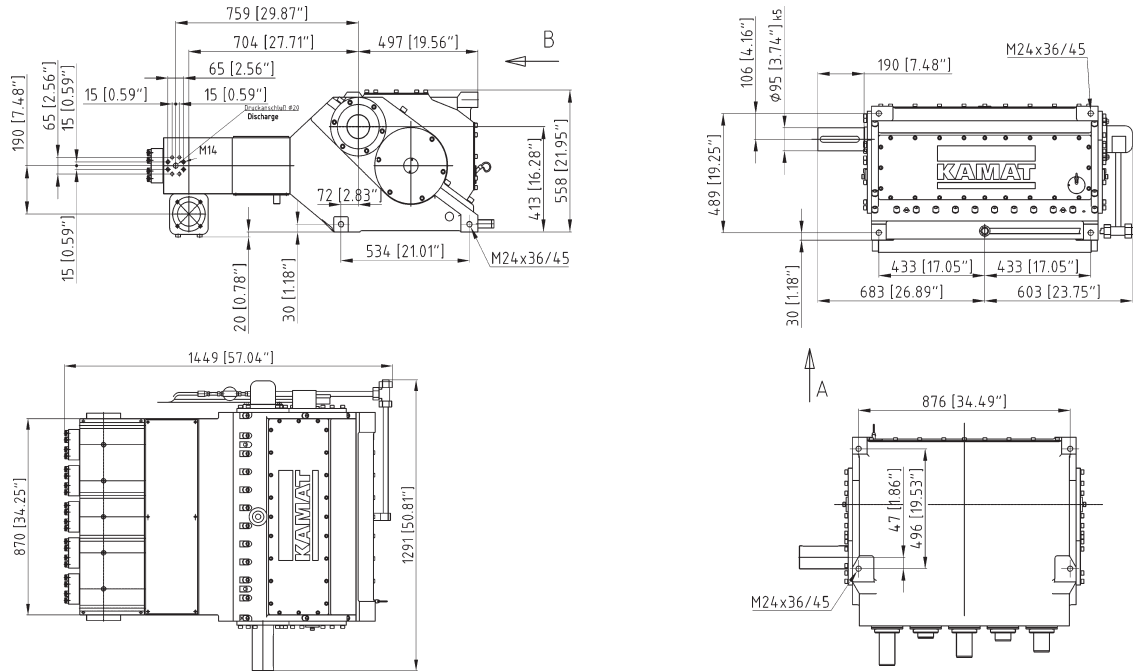

## Compact Head M

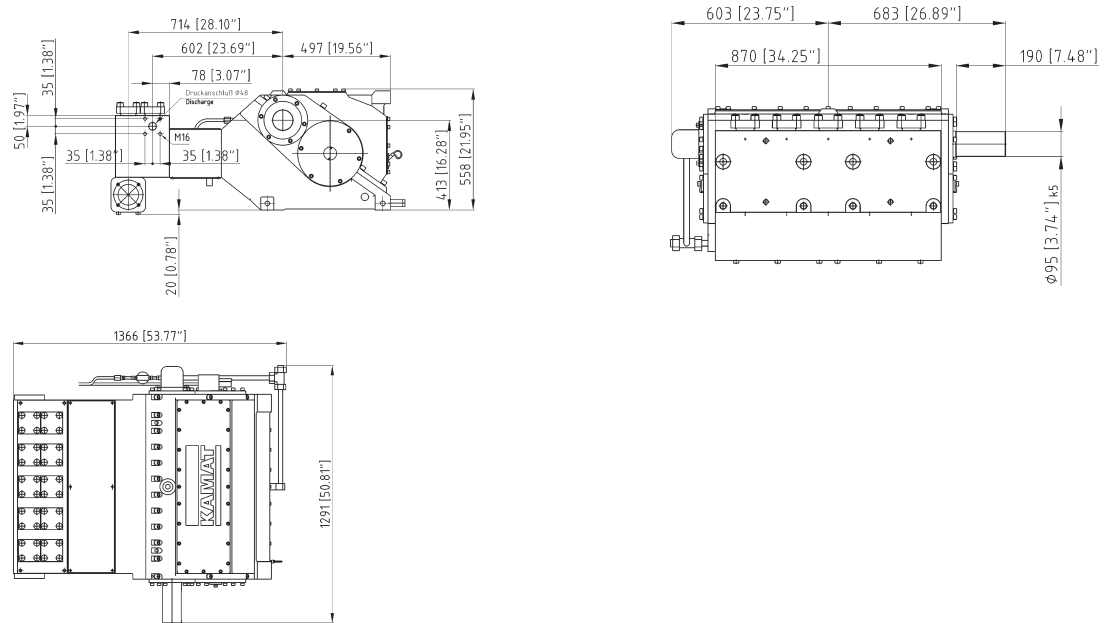

## Compact Head MC

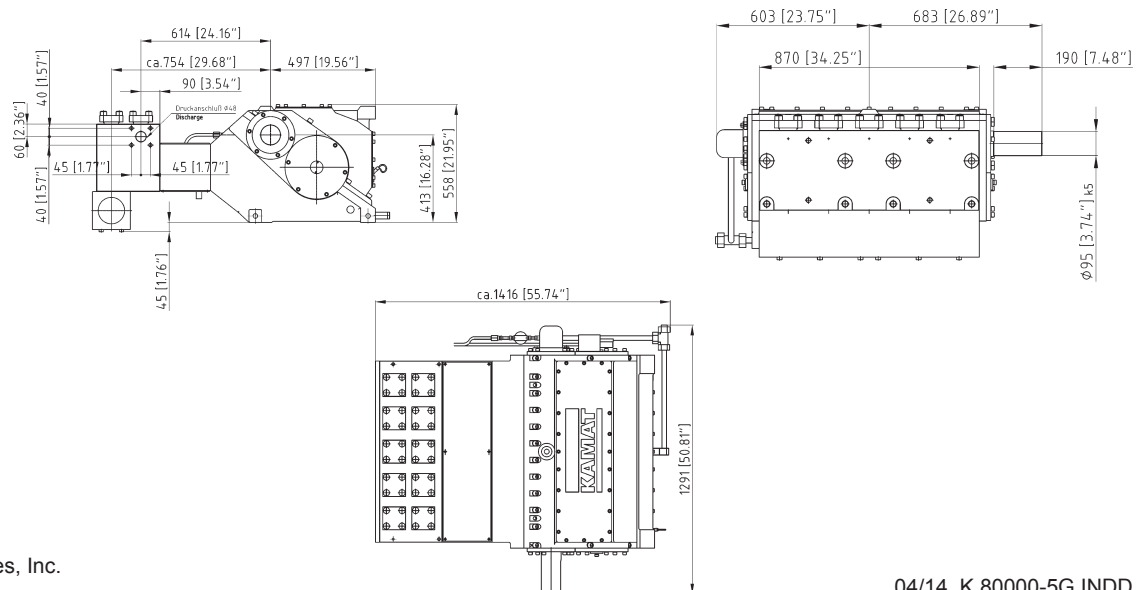

# GIANT

Performance Under Pressure  
GIANT INDUSTRIES, INC.

900 N. Westwood Ave.

Toledo, Ohio 43607

Phone: (419) 531-4600

Fax: (419) 531-6836

www.giantpumps.com

© Copyright 2014 Giant Industries, Inc.